

DIGITUS 2 port 40 Gigabit Ethernet network card, QSFP+, PCI Express, Mellanox chipset

DN-10190
EAN 4016032488019



Dual-Port 40G QSFP Adapter

The DN-10190 Dual-Port 40G QSFP adapter with PCI Express 3.0 and x8 Mellanox Connectx-3 technic delivers high-bandwidth and industry-leading Ethernet connectivity, and is compliant with PCIe2.0 and 1.1. It features two 40 Gigabit QSFP+ Ethernet ports compliant with QSFP+ MSA Spec Rev 1.0, and two QSFP ports supporting FDR-14 InfiniBand or 40Gb Ethernet, with support for InfiniBand FDR speeds of up to 56Gbps (auto-negotiation FDR-10, DDR and SDR). The low-profile form factor adapter with 2u bracket supports virtual protocol interconnect (VPI), InfiniBand Architecture specification v1.2.1, IEEE Std. 802.3, copper cables and optical cables with the use of QSFP connectors, and SFP+ cables available through QSA (Quad to Serial). It enables low latency RDMA over 40Gb Ethernet, with legacy and UEFI PXE network boot support, and supports iSCSI as a software iSCSI initiator in NIC mode with NIC driver. The adapter supports multiple operating systems, such as FreeBSD, Linux 5.x and above, VMware, Windows server2008/2012/2016/2019, win7/win8/win8.1/win10 32 or 64bit. It also supports CORE-Direct, R application off-load, GPUDirect application off-load, RDMA over converged Ethernet (RoCE), end-to-end QoS and congestion control, TCP/UDP/IP stateless off-load, Ethernet encapsulation (EoIB), SR-IOV support (16 virtual functions supported by KVM and Hyper-V(OS dependant) up to a maximum 127 virtual functions supported by the adapter), and traffic steering across multiple cores, making it a versatile adapter suitable for a wide range of applications.

The DN-10190 Dual-Port 40G QSFP adapter with PCIe 3.0 and Mellanox Connectx-3 technology features two 40G QSFP+ Ethernet ports and two QSFP ports supporting FDR-14 InfiniBand or 40Gb Ethernet. It is compatible with various operating systems and offers numerous features such as RDMA, TCP/UDP/IP Off-Load, SR-IOV support, and traffic steering.

- PCI-Express host interface specification v3.0 x8 and Complete with PCIe2.0 and 1.1
- Two 40 Gigabit QSFP+ Ethernet ports
- Compliant with QSFP+ MSA Spec Rev 1.0
- Two QSFP ports supporting FDR-14 InfiniBand or 40Gb Ethernet

- Support for InfiniBand FDR speeds of up to 56Gbps (auto-negotiation FDR-10, DDR and SDR)
- Low-profile form factor adapter with 2u bracket
- Virtual protocol interconnect (VPI)
- InfiniBand Architecture specification v1.2.1 compliant
- IEEE Std. 802.3 compliant
- Compliant with copper cables and optical cables with the use of QSFP connectors.
- Support for SFP+ cables available through QSA (Quad to Serial)
- CORE-Direct, R application off-load
- GPUDirect application off-load
- RDMA over converged Ethernet (RoCE)
- End-to-End QoS and congestion control
- TCP/UDP/IP stateless off-load
- Ethernet encapsulation (EoIB)
- SR-IOV support; 16 virtual functions supported by KVM and Hyper-V(OS dependant) up to a maximum 127 virtual functions supports by the adapter
- Enables low latency RDMA over 40Gb Ethernet (supported with both non-virtualized and SR-IOV enable virtualized servers)—latency as low as 1us
- Traffic steering across multiple cores
- Microsoft VMQ/VMware Net Queue support
- Industry-leading throughput and latency performance
- Legacy and UEFI PXE network boot support
- Supports iSCSI as a software iSCSI initiator in NIC mode with NIC driver
- Supports Operation Systems: FreeBSD, Linux5.x and above, VMware, Windows server2008/2012/2016/2019, win7/win8/win8.1/win10 32 or 64bit
- Supports operating systems: FreeBSD, Linux5.x and higher, VMware, Windows server2008/2012/2016/2019, win7/win8/win8.1/win10 32 or 64 bit

Package contents

- 1 x Dual-Port 40G QSFP adapter
- 1 x User's Manual
- 1 x CD Driver
- 1 x Low profile bracket

Logistics						
	Number (pcs)	Weight (kg)	Depth (cm)	Width (cm)	Height (cm)	cm ³
Packaging Unit Carton	20	5.69	39.00	41.00	41.00	65,559.00
Packaging Unit Inside	1	0.28	0.00	0.00	0.00	0.00
Packaging Unit Single	1	0.28	3.00	15.50	22.00	1,023.00
Net single without Packaging	1	0.28	3.00	15.50	22.00	1,023.00

More images:

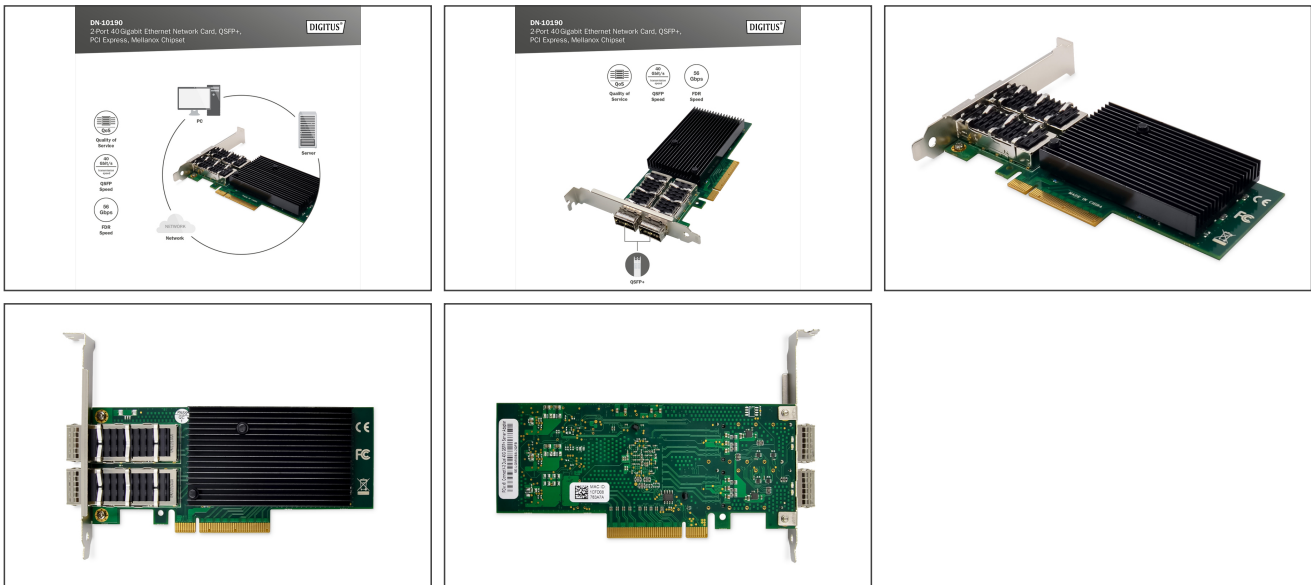

Safety notes

- Switch off the computer completely and disconnect it from the power supply before installing or removing the network card.
- Static discharge can damage the product or the PC. Take measures against static discharge (ESD) when installing the product, e.g. wear an antistatic wrist strap.
- Before installation, touch the metal surface of the PC housing or another grounded object to ground any ESD charge via the housing.
- Avoid using too much force when connecting the product to the PC.
- Please ensure that any cables are connected correctly without overstretching or damaging them.
- Avoid touching the contacts of the product with your fingers to prevent corrosion or static charge.

EU responsible person

EU based economic operator ensuring the product complies with the required regulations.

ASSMANN Electronic GmbH
 Auf dem Schüffel 3
 Lüdenscheid, Germany
<https://www.assmann.com>
info@assmann.com