

# DIGITUS OnLine UPS system, 10 kVA/ 10 kW

DN-170107

EAN 4016032473558



## OnLine UPS Module, 10000VA/10000W 2U

The DIGITUS® OnLine UPS is a double-conversion UPS solution that provides best-in-class power failure protection and continuous power generation in a compact and flexible system. The single-phase UPS operates with high energy efficiency and is ideal for protecting critical infrastructure in both centralized and edge network applications. Scalable runtime options with matching external battery cabinets provide additional flexibility when extended uninterruptible power is required. The user-friendly LCD display and network management capability, including configuration, make this system easy to install and maintain. With market-leading efficiency and consistent power factor, the UPS meets your critical application needs. The UPS has no internal batteries, these must be ordered separately as external battery modules (part number: DN-170108)

**The parallel-redundant online USV is an ideal backup solution for your demanding power requirements and ensures fail-safe operation in a variety of industrial applications.**

- Online double conversion system (VFI-SS-111)
- Input: Input terminals / fixed wiring
- Output: Output terminals / fixed wiring
- Nominal system power: 10 kVA / 10 kW, power factor 1.0
- AC-AC (online VFI) efficiency: 94 %, ECO mode efficiency: 97 %.
- No internal battery. External battery module: DN-170108 Up to 4 ECB can be connected.
- Network connection: Optional SNMP/Webcard (part number DN-170100) enables the UPS to be monitored remotely.
- Optional relay card (part number DN-xxxxx) with potential-free inputs and outputs (bypass, UPS ON, AC error, Batt low, UPS alarm)
- Local communication ports: USB, RS-232 (serial), SNMP card (optional), relay card (optional)
- Emergency Power-off (EPO) contact for switching off the UPS in an emergency
- Maximum operating temperature: 0 - 40 °C

- Storage temperature: -25 - 55 °C
- Relative humidity: 20 - 90% non-condensing
- Operating altitude: < 1500 m
- Product dimensions WxDxH (mm): 440 (19") x 620 x 86.5 (2U)
- Product weight: 15.8 kg
- Shipping dimensions WxDxH (mm): 615 x 765 x 214
- Shipping weight: 20.9 kg
- Overload capacity: 105%-110% (10min), 110%-130% (1min), ≥130% (200ms)
- Safety standards: IEC/EN62040-1, IEC/EN60950-1
- EMC standards: IEC/EN62040-2, IEC61000-4-2, IEC61000-4-3, IEC61000-4-4, IEC61000-4-5, IEC61000-4-6, IEC61000-4-8
- Approval: CE declaration
- Scope of delivery: UPS device (without internal battery), UPS manual, UPS QSG, feet for tower installation, UPS software license, USB cable, 19" installation bracket
- Optionally available: 19" UPS mounting kit (profile rails), article number DN-170109

### Attributes

- Installation: Desktop, Rack
- Plug: Hardwired
- Power: 6000VA – 10000VA
- Technology: Online double conversion
- Inch form factor (IEC 60297): 482.6 mm (19")

### Package contents

- 1 x OnLine USV system, 10 kVA / 10 kW
- 1 x User manual
- 1 x USB connection cable 1.5 m
- 1 x RS232 cable 1.5m
- 1 x Parallel cable 1.5 m
- Software License Card
- Note: Battery not included in delivery

## Logistics

	Number (pcs)	Weight (kg)	Depth (cm)	Width (cm)	Height (cm)	cm³
Packaging Unit Carton	1	20.60	79.50	55.50	20.20	89,127.50
Packaging Unit Inside	1	20.60	0.00	0.00	0.00	0.00
Packaging Unit Single	1	20.60	76.50	61.50	21.40	100,682.00
Net single without Packaging	1	19.32	76.50	61.50	21.40	100,682.00

**More images:**

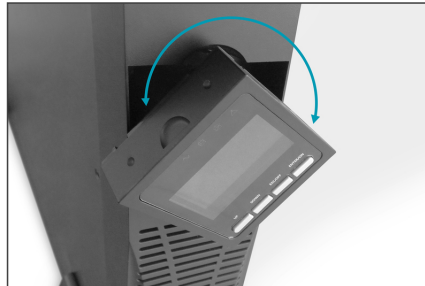
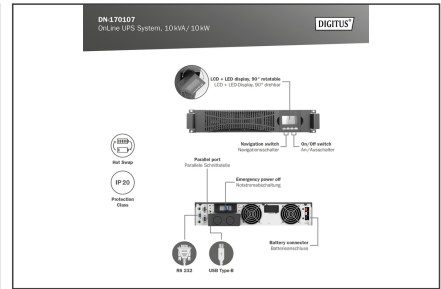
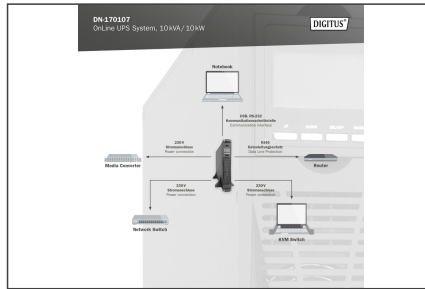

**Safety notes**

- The UPS system must be absolutely dry before it is installed. Please allow the UPS system to acclimatize for at least two hours to adapt to the environment.
- Protect the UPS system from water or moisture.
- Avoid direct sunlight or installation near heat sources.
- Do not block any ventilation openings in the housing.
- Do not connect any devices or appliances that would overload the system.
- Lay cables so that nobody can step on them or trip over them.
- Do not connect any household appliances to the output sockets of the UPS system.
- Only connect the UPS system to an earthed and easily accessible socket.
- Only use VDE-tested, CE-marked mains connection cables at the input and outputs.
- Never disconnect the mains connection cable during operation as this would cancel the protective earthing of the UPS system and all connected loads.
- The UPS system has its own internal power source. The output sockets or output terminals of the UPS system can be energized even if the UPS system is not connected to the building cabling.
- To switch off the UPS system completely, first press the OFF/Enter button to disconnect the mains.
- Caution - Risk of electric shock. Even after disconnecting the device from the mains, the components inside the UPS system are still connected to the battery. There is a risk of electric shock.
- Only persons who are sufficiently familiar with batteries and the necessary safety precautions may replace batteries and monitor operation.
- Caution - Risk of electric shock. The battery circuit is not isolated from the input voltage. Dangerous voltages can occur between the battery terminals and the ground. Ensure that no voltage is present before touching!
- When replacing the batteries, install the same number and type of batteries.
- Do not open or destroy batteries. Leaking electrolyte can injure the skin and eyes and may be toxic.
- The appliance may only be opened and repaired by a trained specialist.

**EU responsible person**

EU based economic operator ensuring the product complies with the required regulations.

ASSMANN Electronic GmbH  
Auf dem Schüffel 3  
Lüdenscheid, Germany  
<https://www.assmann.com>  
[info@assmann.com](mailto:info@assmann.com)