

DIGITUS CAT 5e U/UTP patch cord

DK-1512-010/BL
EAN 4016032317838



CAT 5e U-UTP patch cord, PVC AWG 26/7, length 1 m, color black

The new DIGITUS® Patch Cords series is back with a reworked plug on the market. The bend protection sleeve with latch protection prevents snagging the cable and also protects the latching lever before break. The connector can be different in color depending on the category: A blue plug for CAT5e, a red plug for CAT6 and a yellow plug for CAT6A. We also offer a variety of different colors and lengths to meet all demands. For more information, please see our Patch Cord brochure!

Future-oriented standards and high-end quality for your network.

- 2x RJ45 (8P8C) connectors
- Boots with kink protection, strain relief and latch protection
- Length marking on boot

Attributes

- Assortment: Twisted Pair Patch Cables
- Configuration: 1:1
- Connector 1: Modular RJ45 (8/8) plug
- Connector 2: Modular RJ45 (8/8) plug
- Packaging: DIGITUS Polybag
- Category: CAT 5e
- Shielding: U-UTP, unshielded
- Length: 1 m
- Color: black
- Jacket: PVC
- Slim Version: no
- Structure: 4 x 2 AWG 26/7, twisted pair
- Flat Version: no

Logistics

	Number (pcs)	Weight (kg)	Depth (cm)	Width (cm)	Height (cm)	cm³
Packaging Unit Carton	200	6.10	36.00	36.00	22.00	28,512.00
Packaging Unit Inside	10	0.31	25.00	14.00	4.00	1,400.00
Packaging Unit Single	1	0.03	20.00	10.00	2.00	400.00
Net single without Packaging	1	0.03	20.00	10.00	2.00	400.00

More images:

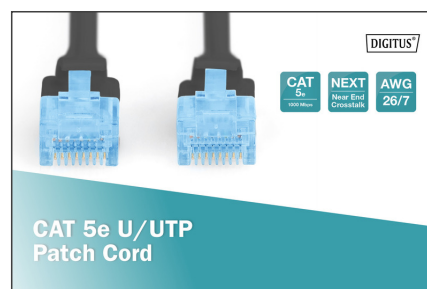
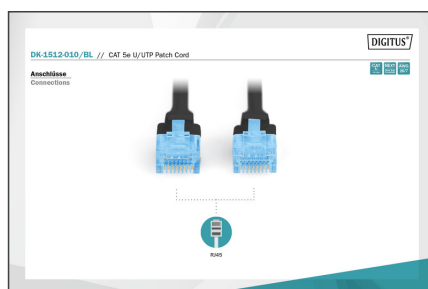
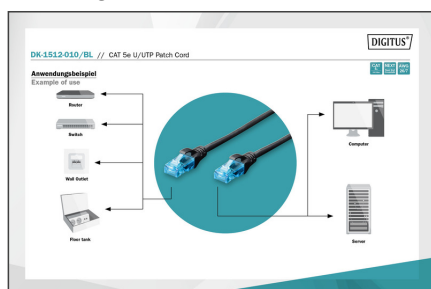

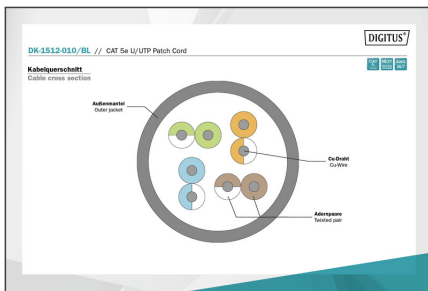
**Safety notes**

- When plugging and unplugging the cable, only grasp the plug and do not pull directly on the cable.
- Cables must not be kinked sharply or bent at tight angles, as this can damage the inner wires and lead to failures.
- Ensure that the cables are not under tensile load, as this can damage the insulation and the wires inside the cable.
- Ensure that cables are not laid in areas where they can be easily damaged mechanically.
- Cables should not be used in environments with extremely high or very low temperatures. Observe the product information on the maximum operating temperature of the cable.
- Check cables regularly for visible damage such as cracks, kinks or signs of wear. Defective cables should be replaced immediately to avoid failures, short circuits or even electric shocks.

EU responsible person

EU based economic operator ensuring the product complies with the required regulations.

ASSMANN Electronic GmbH
Auf dem Schöffel 3
Lüdenscheid, Germany
<https://www.assmann.com>
info@assmann.com