

# ednet HDMI High Speed connection cable with Ethernet, type A, high flexible

84458  
EAN 4054007844583

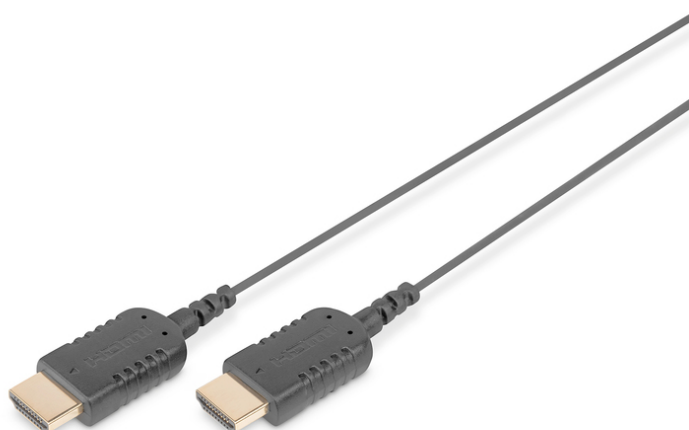

## HDMI High Speed connection cable, type A, HighFlex M/M, 2.0m, w/Ethernet, 4K Ultra HD@30Hz, active

This UHD and Full 3D capable cable is used to connect audio-video devices with Mini HDMI (Type C) interface, such as notebooks, to a TV, monitor or PC. The double shielded cable connects an HDMI socket with a Mini HDMI socket. ARC & CEC and resolutions up to 4K are supported. In addition, this cable transmits network signals from compatible devices, you do not need a separate Ethernet cable. The cable is also characterized by a small diameter and highest flexibility.

### Connect devices with HDMI jacks to Mini HDMI jacks - with Ethernet over HDMI

- Supports 4K/2K with 30Hz
- Supports 3D
- Supports Audio Return Channel (ARC)

- Supports Consumer Electronic Control (CEC)
- Supports Ethernet over HDMI
- AWG: 30
- HDMI-norma: HDMI velike brzine s Ethernetom
- HDTV-norma: Ultra HD 4K
- Kabel u boji: crni
- Kapice: ukalupljeno
- Konektor 1: HDMI tip A, utikač
- Konektor 2: HDMI tip A, utikač
- Konektor u boji: crni
- Materijal žice: CU
- Površina konektora: pozlaćeno
- Duljina: 2 m
- AOC - aktivni optički kabel: Ne
- oklop: dvostruki oklop

Logistics						
	Number (pcs)	Weight (kg)	Depth (cm)	Width (cm)	Height (cm)	cm <sup>3</sup>
Packaging Unit Carton	100	4.70	50.00	35.00	29.50	51.63
Packaging Unit Inside	1	0.05	9.50	7.50	3.60	256.50
Packaging Unit Single	1	0.05	9.50	7.50	3.60	256.50
Net single without Packaging	0	0.03	2.00	1.00	1.00	2.00

### More images:



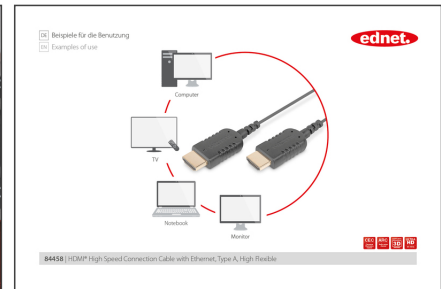
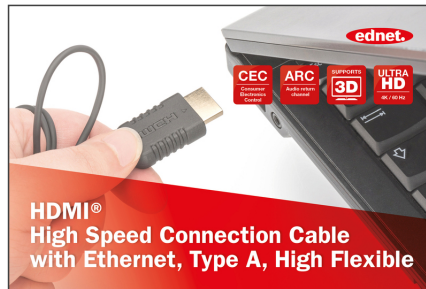

### Safety notes

- When plugging and unplugging the cable, only grasp the plug and do not pull directly on the cable.
- Cables must not be kinked sharply or bent at tight angles, as this can damage the inner wires and lead to failures.
- Make sure that the cables are not under tensile load, as this can damage the insulation and the wires inside the cable.
- Ensure that cables are not laid in areas where they can be easily damaged mechanically.
- Cables should not be used in environments with extremely high or very low temperatures. Observe the product information on the maximum operating temperature of the cable.
- Check cables regularly for visible damage such as cracks, kinks or signs of wear. Defective cables should be replaced immediately to avoid failures, short circuits or even electric shocks.

### EU responsible person

EU based economic operator ensuring the product complies with the required regulations.

ASSMANN Electronic GmbH  
Auf dem Schüffel 3  
Lüdenscheid, Germany  
<https://www.assmann.com>  
[info@assmann.com](mailto:info@assmann.com)