

DIGITUS SOHO PRO wall-mounted enclosure - 254 mm (10") - 315x300 mm (WxD)

DN-49101
EAN 4016032493631



10" 6U wall mounting cabinet, SOHO PRO 325 x 315 x 300 mm, black

Whether in the home, office or in sub-distribution boards with limited space: With the compact 254 mm (10") solutions from the SOHO PRO series, you can install your network wherever you want. Available in three height units (6U, 9U, 12U), the wall-mounted enclosures are equipped with a full glass door and a cable entry in the roof and base. A pair of galvanized 254 mm (10") profile rails labelled with legible height units are installed inside. These can be adjusted in depth. Each cabinet is a robust steel construction made of up to 1.5 mm thick sheet steel. The coloring takes the form of electrostatic powder coating in the standard colors grey (RAL 7035) and black (RAL 9005). The door hinges can be changed. The network enclosures are supplied unassembled in an optimized flat pack. Assembly takes place in just a few steps and is child's play thanks to the enclosed step-by-step instructions.

The DIGITUS® wall-mounted enclosure SOHO PRO series is characterized by its efficient delivery in an optimized flat pack and particularly user-friendly installation.

- Protection class IP20
- Lockable safety glass door
- 200° door opening angle
- 1-point locking on the front door

- 254 mm (10") profile rails mounted at the front inside the enclosure, galvanized
- 254 mm (10") profile rails are adjustable in depth
- 1.1 - 1.5 thick sheet steel with a high load-bearing capacity, powder-coated
- Cable entry with brush strip in the roof and with plastic cover in the floor
- Ventilation slots for active and passive ventilation
- Installation depth for components max.: 254 mm
- Product dimensions (H x W x D): 325 x 315 x 300mm
- Packaging dimensions (H x W x D): 175 x 360 x 340 mm
- Weight (net / gross): 5.01 / 5.25 kg
- Bočne ploče: Objе strane
- Boja: crna, RAL 9005
- Jedinice: 6
- Kapacitet opterećenja: 30 kg
- Prednja vrata: Staklena vrata, jednostruko otvaranje
- Širina: 316 mm
- Vrsta ormara: Zidni ormarić
- IP klasa zaštite: IP20
- Montirano: Ne

Package contents

- Installation set (screws, cage nuts, washers)
- 2x key
- 1x QIG

Logistics						
	Number (pcs)	Weight (kg)	Depth (cm)	Width (cm)	Height (cm)	cm³
Packaging Unit Carton	1	5.25	34.00	36.00	17.50	21,420.00
Packaging Unit Inside	1	5.25	34.00	36.00	17.50	21,420.00
Packaging Unit Single	1	5.25	34.00	36.00	17.50	21,420.00
Net single without Packaging	0	5.01	30.00	31.50	32.50	30,712.50

More images:

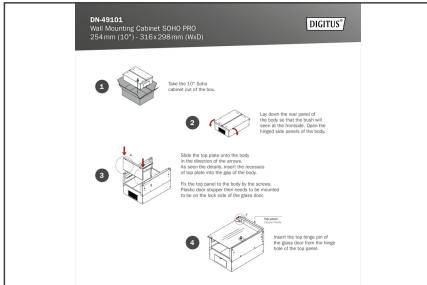
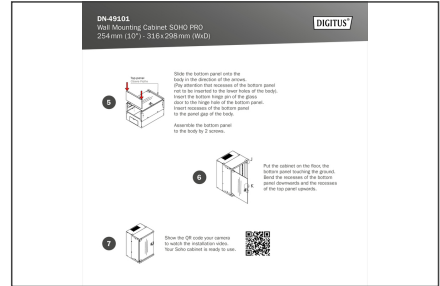

DN-45101
Wall Mounting Cabinet SSHD PRO
254mm (10") x 316 x 298mm (WD)

DIGITUS

1. Take the 12" plate cabinet out of the box.
2. Lay down the rear panel of the body so that the top edge is at the bottom. Open the trigger side panels of the body.
3. Slide the top plate into the hole in the direction of the arrow. In the direction of the arrow, the trigger catches. Adjust the position of the plate into the gap of the body. The top edge of the body is the bottom. Please check whether the screws to be inserted to the top edge of the plate.
4. Insert the top trigger part of the plate into the trigger hole of the top panel.

DN-45101
Wall Mounting Cabinet SSHD PRO
254mm (10") x 316 x 298mm (WD)

DIGITUS

1. Slide the top plate into the hole in the direction of the arrow. The arrow shows the direction of the trigger catch. The trigger catches in the direction of the arrow. Please check whether the screws to be inserted to the top edge of the plate.
2. Insert the top trigger part of the plate into the trigger hole of the top panel.
3. Push the cabinet on the floor. The bottom panel catches the plate. Check the position of the plate. Please check whether the screws to be inserted to the top edge of the plate.
4. Check the QR code your camera to read the installation instructions. Your QR code is ready to use.