

# DIGITUS CAT 6 S-FTP Patch Cable

DB-160144-020-S  
EAN 4016032384045

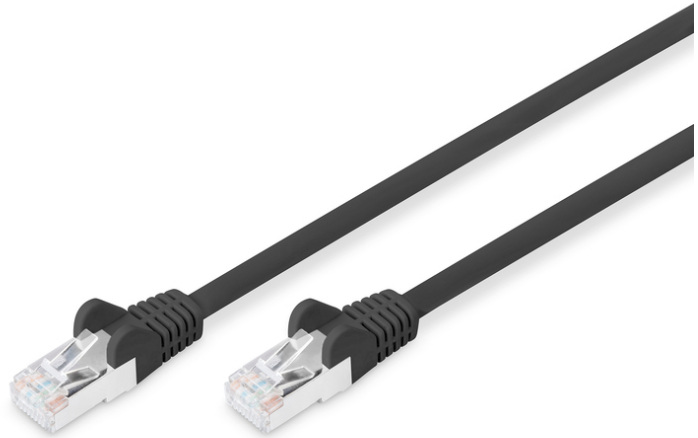

**Patch Cord, CAT6, RJ45 M/M, 2.0m, S-FTP, AWG 27/7, LSZH, bl**

This network cable is suitable e.g. for the connection in network cabinets. Another area of application is the wiring of the DSL telephone system.

**Future-oriented standards and high-end quality for your network.**

- LSZH - low smoke zero halogen

**Attributes**

- Assortment: Twisted Pair Patch Cables
- Color cable: black

- Color connector: black
- Connector 1: Modular RJ45 (8/8) plug
- Connector 2: Modular RJ45 (8/8) plug
- Hoods: plastic
- Wire material: CU
- Category: CAT 6
- Shielding: S-FTP, pairs in metal foil and braid shielding
- Length: 2 m
- Slim Version: no
- Structure: 4 x 2 AWG 27/7, twisted pair
- Flat Version: no

Logistics						
	Number (pcs)	Weight (kg)	Depth (cm)	Width (cm)	Height (cm)	cm <sup>3</sup>
Packaging Unit Carton	40	6.80	54.00	26.00	36.00	50.54
Packaging Unit Inside	10	1.70	50.00	25.00	9.00	11.25
Packaging Unit Single	1	0.17	5.00	7.50	23.50	881.25
Net single without Packaging	0	0.06	3.00	6.00	20.00	360.00

**More images:**

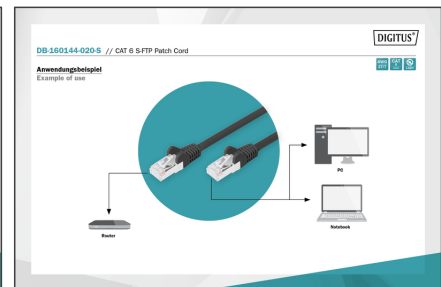
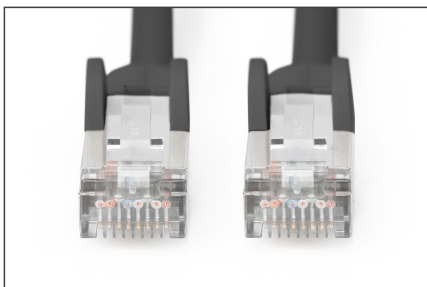

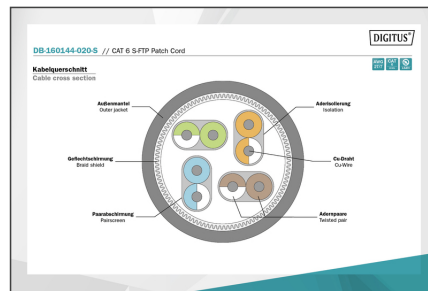
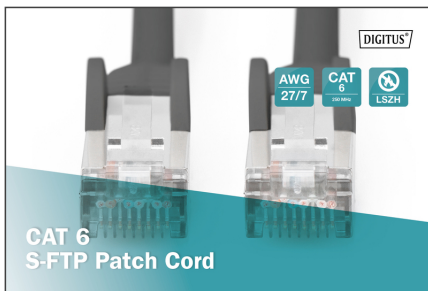

**Safety notes**

- When plugging and unplugging the cable, only grasp the plug and do not pull directly on the cable.
- Cables must not be kinked sharply or bent at tight angles, as this can damage the inner wires and lead to failures.
- Ensure that the cables are not under tensile load, as this can damage the insulation and the wires inside the cable.
- Ensure that cables are not laid in areas where they can be easily damaged mechanically.
- Cables should not be used in environments with extremely high or very low temperatures. Observe the product information on the maximum operating temperature of the cable
- Check cables regularly for visible damage such as cracks, kinks or signs of wear. Defective cables should be replaced immediately to avoid failures, short circuits or even electric shocks.

**EU responsible person**

EU based economic operator ensuring the product complies with the required regulations.

ASSMANN Electronic GmbH  
 Auf dem Schüffel 3  
 Lüdenscheid, Germany  
<https://www.assmann.com>  
[info@assmann.com](mailto:info@assmann.com)