

# DIGITUS Prespojni kabel Kat.5e U/UTP

DK-1511-005/B  
EAN 4016032212126

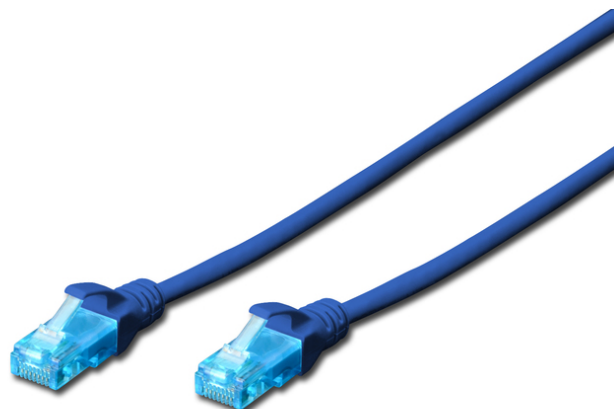

**AMCU 80005 PATCH KABEL 0,5m PLAVI AWG 26/7, length 0.5 m, color blue**

Prespojni kabeli DIGITUS® Kat. 5e klase D proizvedeni su i testirani sukladno ISO/IEC 11801 i DIN EN 50173 Kat. 5e specifikacijama. Garantiraju sukladnost ugrađenog sustava ožičenja zahtjevima specifikacija ISO & EN kanala i omogućuju optimalne razine performansi DIGITUS® kategorije 5e kabliranja. Performanse su testirane na propusnosti do 100 MHz uključujući karakteristike performansi kao što je gubitak preslušavanja na bližem kraju ("NEXT"). DIGITUS® prespojni kabeli dizajnirani su i proizvedeni kako bi u potpunosti zadovoljili uporabu u različitim i najzahtjevnijim aplikacijama. Svaki kabel opremljen je s pregibnicom i zaštitom. Osim toga, pregibnica je opremljena sa zaštitom polugice mikroutikača. Prespojni kabel Kat. 5 jednostavno je prepoznati po konektoru prozirne plave boje.

**Vrhunsku kvalitetu Vaše mreže osigurava oprema proizvedena sukladno najnovijim standardima.**

- 2x RJ45 (8P8C) mikroutikača

- Pregibnica je opremljena sa zaštitom polugice mikroutikača
- Oznaka dužine na pregibnici
- Vodič: Bakar (Cu)

**Attributes**

- Ambalaža: DIGITUS Polybag
- Asortiman: Patch kabeli s upredenim paricama
- Konektor 1: Modularni RJ45 (8/8) utikač
- Konektor 2: Modularni RJ45 (8/8) utikač
- Konfiguracija: 1:1
- Kategorija: CAT 5e
- Oklop: U-UTP, neoklopljeno
- Duljina: 0.5 m
- Boja: plavi
- Kapica: PVC
- Struktura: 4 x 2 AWG 26/7, upletena parica
- Tanka verzija: Ne
- Flat Version: Ne

Logistics						
	Number (pcs)	Weight (kg)	Depth (cm)	Width (cm)	Height (cm)	cm³
Packaging Unit Carton	250	6.20	36.00	36.00	22.00	28.51
Packaging Unit Inside	10	0.25	4.80	22.00	28.00	2,956.80
Packaging Unit Single	1	0.02	1.60	11.50	21.00	386.40
Net single without Packaging	0	0.02	50.00	1.17	1.27	74.30

**More images:**

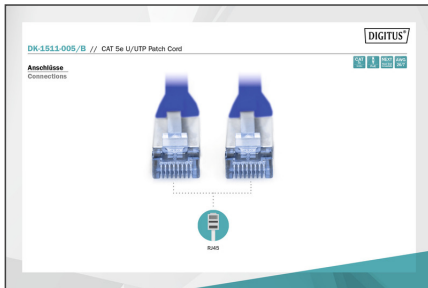
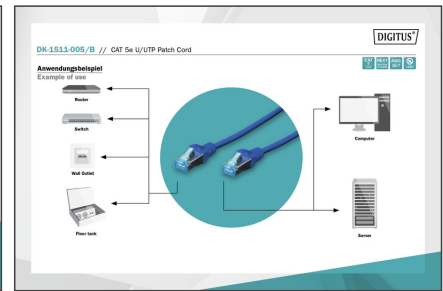
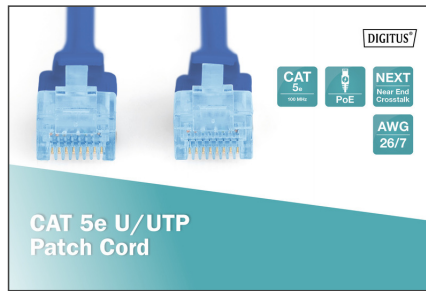
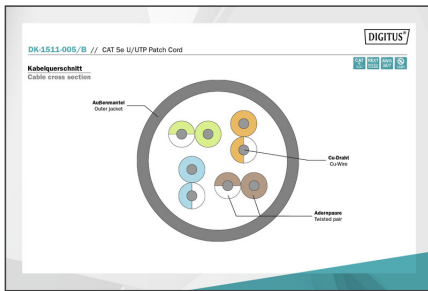

**Safety notes**

- When plugging and unplugging the cable, only grasp the plug and do not pull directly on the cable.
- Cables must not be kinked sharply or bent at tight angles, as this can damage the inner wires and lead to failures.
- Ensure that the cables are not under tensile load, as this can damage the insulation and the wires inside the cable.
- Ensure that cables are not laid in areas where they can be easily damaged mechanically.
- Cables should not be used in environments with extremely high or very low temperatures. Observe the product information on the maximum operating temperature of the cable
- Check cables regularly for visible damage such as cracks, kinks or signs of wear. Defective cables should be replaced immediately to avoid failures, short circuits or even electric shocks.

**EU responsible person**

EU based economic operator ensuring the product complies with the required regulations.

ASSMANN Electronic GmbH  
 Auf dem Schüffel 3  
 Lüdenscheid, Germany  
<https://www.assmann.com>  
[info@assmann.com](mailto:info@assmann.com)