

# DIGITUS USB Type-C connection cable, Gen2, Type-C to A

AK-300146-010-S  
EAN 4016032438298



**USB Type-C connection cable, type C to A M/M, 1.0m, Gen2, 3A, 10GB, 3.1 Version, bl**

For connection of external USB devices (with C socket, e. g. PC, Tablet or Smartphone) to the USB Host (e. g. PC, Notebook). Datatransferrate up to 10 Gbps (Superspeed+).

**For superfast synchronising and charging**

- SuperSpeed+ data transmissions up to 10 Gbit/s - 20x faster than USB 2.0
- Supports up to 3A Power supply
- Support of USB PD (Power Delivery) specification
- Type-C connector can be used in both directions
- Downward compatible to USB 2.0 and 1.1

**Attributes**

- Assortment: USB Cables
- AWG: 24/28
- Color cable: black
- Color connector: black
- Connector 1: USB C, plug
- Connector 2: USB A, plug
- Connector surface: nickel-plated
- Hoods: molded
- Packaging: Polybag
- Wire material: CU
- Length: 1 m
- Shielding: Double shielding
- USB-C Products: yes

Logistics						
	Number (pcs)	Weight (kg)	Depth (cm)	Width (cm)	Height (cm)	cm <sup>3</sup>
Packaging Unit Carton	200	10.00	32.00	50.00	21.00	33,600.00
Packaging Unit Inside	10	0.50	20.00	30.00	7.00	4,200.00
Packaging Unit Single	1	0.05	24.00	13.00	5.00	1,560.00
Net single without Packaging	1	0.00	0.00	0.00	0.00	0.00

**More images:**



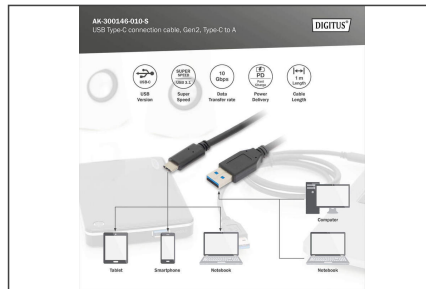

**Safety notes**

- When plugging and unplugging the cable, only grasp the plug and do not pull directly on the cable.
- Cables must not be kinked sharply or bent at tight angles, as this can damage the inner wires and lead to failures.
- Make sure that the cables are not under tensile load, as this can damage the insulation and the wires inside the cable.
- Ensure that cables are not laid in areas where they can be easily damaged mechanically.
- Cables should not be used in environments with extremely high or very low temperatures. Observe the product information on the maximum operating temperature of the cable
- Check cables regularly for visible damage such as cracks, kinks or signs of wear. Defective cables should be replaced immediately to avoid failures, short circuits or even electric shocks.

**EU responsible person**

EU based economic operator ensuring the product complies with the required regulations.

ASSMANN Electronic GmbH  
 Auf dem Schüffel 3  
 Lüdenscheid, Germany  
<https://www.assmann.com>  
[info@assmann.com](mailto:info@assmann.com)