

# DIGITUS HDMI High Speed with Ethernet Connection Cable

AK-330107-100-S  
EAN 4016032307051

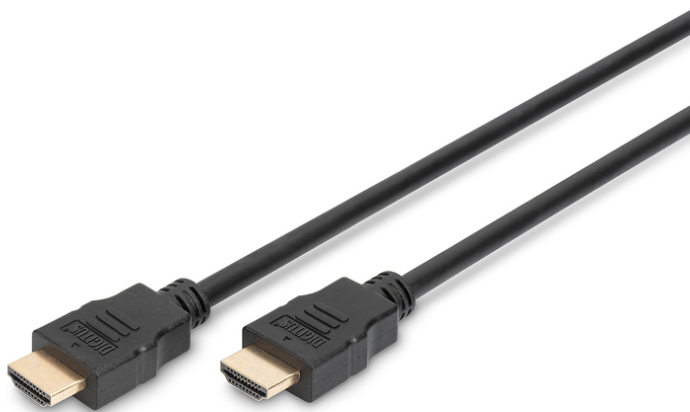

**HDMI High Speed Connection Cable, Type A M/M, 10.0m, Full HD, 1080P@60Hz, gold, bl**

This HD and 3D suitable cable used for connection of audio/video devices, such as Blu-ray player, game pads or consoles, etc., for example, with a TV, monitor or computer. Also capable for use of any IP-based application.

**Full HD audio/video transmission (1080p)**

- Support up to 1080p with 60Hz
- Support 3D
- Support Audio Return Channel (ARC)
- Support Consumer Electronic Control (CEC)
- Support Lip-Sync (audio/video synchronisation)
- Dolby TrueHD capable
- With Ethernet Channel (HEC)

**Attributes**

- Assortment: HDMI Cables
- AWG: 28
- Color cable: black
- Color connector: black
- Connector 1: HDMI type A, plug
- Connector 2: HDMI type A, plug
- Connector surface: gold-plated
- HDMI Standard: High Speed HDMI with Ethernet
- HDTV Resolution max.: 1920 x 1200 Pixel, 60Hz
- HDTV Standard: Full HD
- Hoods: molded
- Packaging: Polybag
- Wire material: CU
- Length: 10 m
- AOC - Active Optical Cable: no
- Shielding: triple shielding

Logistics						
	Number (pcs)	Weight (kg)	Depth (cm)	Width (cm)	Height (cm)	cm³
Packaging Unit Carton	22	14.26	45.00	32.00	25.00	36,000.00
Packaging Unit Inside	1	0.65	5.00	23.00	27.00	3,105.00
Packaging Unit Single	1	0.65	32.00	23.00	2.00	1,472.00
Net single without Packaging	1	0.64	28.00	20.00	5.00	0.00

**More images:**

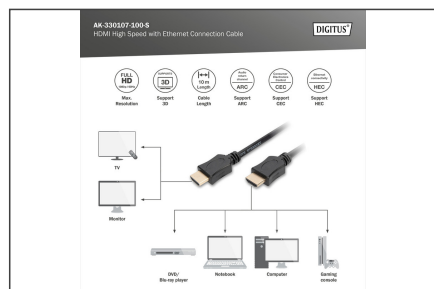

**Safety notes**

- When plugging and unplugging the cable, only grasp the plug and do not pull directly on the cable.
- Cables must not be kinked sharply or bent at tight angles, as this can damage the inner wires and lead to failures.
- Make sure that the cables are not under tensile load, as this can damage the insulation and the wires inside the cable.
- Ensure that cables are not laid in areas where they can be easily damaged mechanically.
- Cables should not be used in environments with extremely high or very low temperatures. Observe the product information on the maximum operating temperature of the cable
- Check cables regularly for visible damage such as cracks, kinks or signs of wear. Defective cables should be replaced immediately to avoid failures, short circuits or even electric shocks.

**EU responsible person**

EU based economic operator ensuring the product complies with the required regulations.

ASSMANN Electronic GmbH  
Auf dem Schüffel 3  
Lüdenscheid, Germany  
<https://www.assmann.com>  
[info@assmann.com](mailto:info@assmann.com)