

# DIGITUS DisplayPort Adapter / Converter, DP - HDMI

DB-340400-001-S  
EAN 4016032292296



**DisplayPort Adapter Cable, Type DP-HDMI A M/F, 0.15m,w/interlock, Full HD, DP 1.1a, bl**

This HD video and digital audio adapter/converter is ideally suited for connecting a notebook or computer with DP interface to an HDMI monitor, projector, LCD/TFT monitor, LED or plasma TV using an HDMI cable. A secure hold is ensured by the integrated latch on the DP connection. Just plug in and get started with Plug and Play. The gold-plated contacts ensure optimal HD signal transmission and increase the service life of the plugs.

**This HD video and digital audio adapter/converter is ideally suited for connecting notebooks or computers with DP interface to an HDMI monitor, projector, LCD/TFT monitor, LED or plasma TV using an HDMI cable.**

- Supports up to 1080p with 60 Hz
- Support DP++ Dual-Mode
- Ensures a lower burden of the interface.
- Maximal bandwidth: 10,8 Gbps
- HBR-Version/transfer mode: HBR1 (2,70 Gbit/s per lane)

- HDCP-Version: HDCP 1.3

**Attributes**

- Assortment: DisplayPort Cables
- AWG: 28
- Color cable: black
- Color connector: black
- Connector 1: DP, plug
- Connector 2: HDMI type A, jack
- Connector surface: nickel-plated
- DisplayPort standard: DisplayPort 1.1a
- HDTV Resolution max.: 1920 x 1080 Pixel, 60Hz
- HDTV Standard: Full HD
- Hoods: molded
- Interlock: Snap fastener
- Wire material: CU
- Length: 0.15 m
- AOC - Active Optical Cable: no
- Shielding: Double shielding

Logistics						
	Number (pcs)	Weight (kg)	Depth (cm)	Width (cm)	Height (cm)	cm <sup>3</sup>
Packaging Unit Carton	80	6.60	52.00	29.00	39.00	58,812.00
Packaging Unit Inside	20	1.65	27.00	25.00	17.00	11,475.00
Packaging Unit Single	1	0.08	26.50	7.50	2.30	457.13
Net single without Packaging	1	0.05	24.00	2.10	1.20	0.00

**More images:**

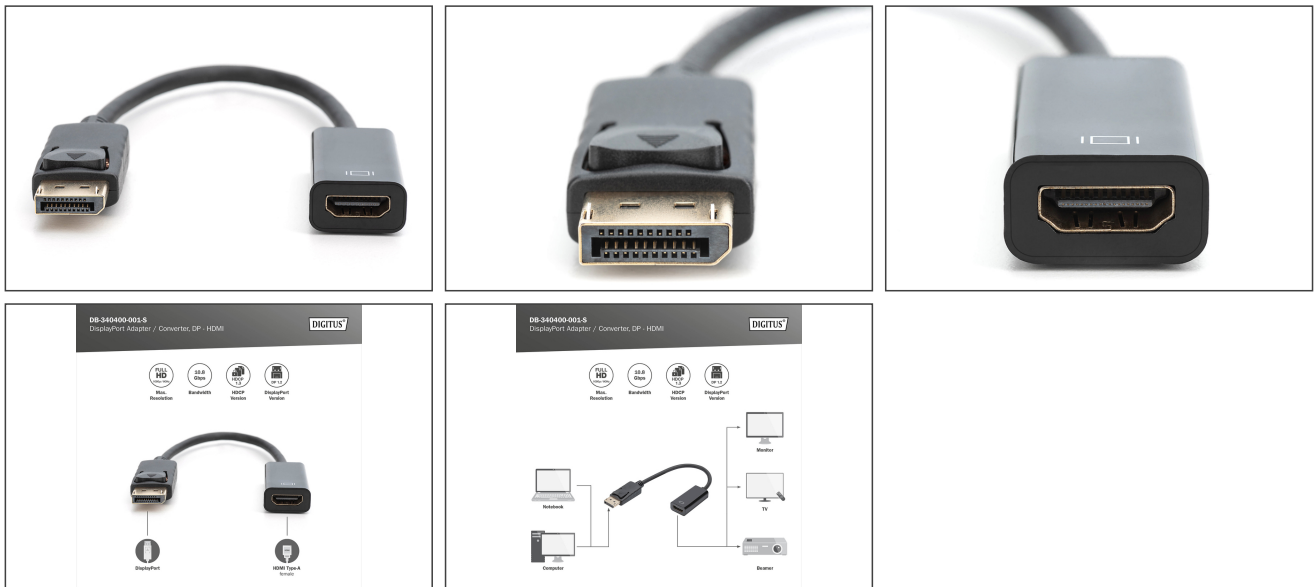

**Safety notes**

- When plugging and unplugging the cable, only grasp the plug and do not pull directly on the cable.
- Cables must not be kinked sharply or bent at tight angles, as this can damage the inner wires and lead to failures.
- Make sure that the cables are not under tensile load, as this can damage the insulation and the wires inside the cable.
- Ensure that cables are not laid in areas where they can be easily damaged mechanically.
- Cables should not be used in environments with extremely high or very low temperatures. Observe the product information on the maximum operating temperature of the cable
- Check cables regularly for visible damage such as cracks, kinks or signs of wear. Defective cables should be replaced immediately to avoid failures, short circuits or even electric shocks.

**EU responsible person**

EU based economic operator ensuring the product complies with the required regulations.

ASSMANN Electronic GmbH  
 Auf dem Schüffel 3  
 Lüdenscheid, Germany  
<https://www.assmann.com>  
[info@assmann.com](mailto:info@assmann.com)