

# DIGITUS Cabo de extensão HDMI de alta velocidade com Ethernet

AK-330201-030-S  
EAN 4016032291145

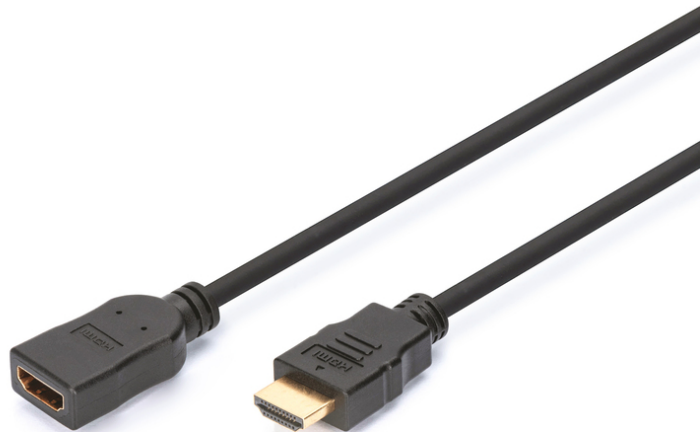

**HDMI High Speed extension cable, type A M/F, 3.0m, w/Ethernet, Ultra HD 24p, gold, bl**

Este cabo Full HD (1080p) e 3D pode ser utilizado como extensão para conexões de áudio/vídeo existentes entre, por exemplo, um aparelho Blu-ray, um console de jogos, etc., e uma TV, monitor ou computador. Pode ser utilizado com qualquer aplicativo baseado no endereço IP.

**Compatível com 4K/Ultra HD e 3D + ligação Ethernet**

- Suporta até 4K com 30 Hz
- Padrão HDMI: 1.4

**Attributes**

- Assortment: HDMI Cables
- AWG: 30
- Color cable: black

- Color connector: black
- Connector 1: HDMI type A, plug
- Connector 2: HDMI type A, jack
- Connector surface: gold-plated
- Ferrite filter: none
- HDMI Standard: High Speed HDMI with Ethernet
- HDTV Resolution max.: 3840 x 2160 Pixel, 30Hz
- HDTV Standard: Ultra HD 4K
- Hoods: molded
- Packaging: Polybag
- Wire material: CU
- Length: 3 m
- AOC - Active Optical Cable: no
- Shielding: triple shielding

Logistics						
	Number (pcs)	Weight (kg)	Depth (cm)	Width (cm)	Height (cm)	cm <sup>3</sup>
Packaging Unit Carton	30	10.80	35.00	26.00	24.00	21,840.00
Packaging Unit Inside	10	3.60	6.00	42.00	41.00	10,332.00
Packaging Unit Single	1	0.36	2.50	14.00	24.00	840.00
Net single without Packaging	1	0.36	0.00	0.00	0.00	0.00

**More images:**



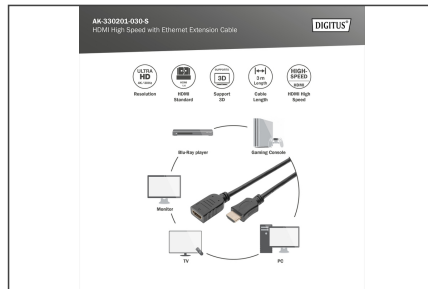

**Safety notes**

- When plugging and unplugging the cable, only grasp the plug and do not pull directly on the cable.
- Cables must not be kinked sharply or bent at tight angles, as this can damage the inner wires and lead to failures.
- Make sure that the cables are not under tensile load, as this can damage the insulation and the wires inside the cable.
- Ensure that cables are not laid in areas where they can be easily damaged mechanically.
- Cables should not be used in environments with extremely high or very low temperatures. Observe the product information on the maximum operating temperature of the cable
- Check cables regularly for visible damage such as cracks, kinks or signs of wear. Defective cables should be replaced immediately to avoid failures, short circuits or even electric shocks.

**EU responsible person**

EU based economic operator ensuring the product complies with the required regulations.

ASSMANN Electronic GmbH  
 Auf dem Schüffel 3  
 Lüdenscheid, Germany  
<https://www.assmann.com>  
[info@assmann.com](mailto:info@assmann.com)