

# DIGITUS Настенная распределительная коробка для пассивного PoE

DN-95002  
EAN 4016032260257



### Passive PoE wall mount box 1x RJ45, 1x DC, 1x PoE

Passive PoE wall mount box, 1x RJ45, 1x DC, 1x PoE

**Упрощает установку устройств с подключением к сети Ethernet, благодаря совмещению данных и питания в одном кабеле**

- RJ45 гнездо LAN
- гнездо питания
- PoE (RJ45) гнездо

- Подходит для вилок питания диам. 5.5 мм
- Скорость соединения: 10/100 Мбит/с
- Назначение контактов: 1/2/3/6 для сети, 4/5/7/8 для блока питания

#### Attributes

- Number of ports: 1
- Industrial usage: no

Logistics						
	Number (pcs)	Weight (kg)	Depth (cm)	Width (cm)	Height (cm)	cm³
Packaging Unit Carton	360	13.42	35.00	35.00	46.00	56,350.00
Packaging Unit Inside	1	0.04	0.00	0.00	0.00	0.00
Packaging Unit Single	1	0.04	2.80	5.10	8.10	115.67
Net single without Packaging	1	0.02	2.40	2.70	5.00	101.00

#### More images:

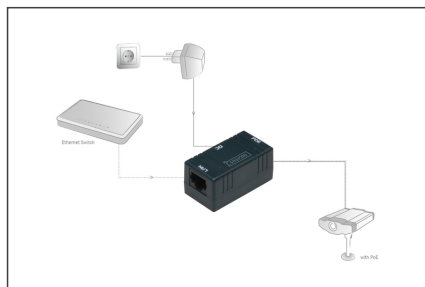

#### Safety notes

- This product is intended for indoor use only.
- Read all instructions and follow all warnings and instructions on the device.
- Do not place this appliance on an unstable surface (such as a trolley, stand, table, etc.).
- Do not use this appliance near water.

- Do not place this appliance near or above a radiator.
- The housing is equipped with openings for heat dissipation and ventilation. To prevent overheating during operation, the ventilation openings must not be blocked or covered.
- Do not place the appliance on a soft surface (e.g. bed, sofa, blanket, etc.). This will block the ventilation.
- The appliance must not be installed in a closed environment if adequate ventilation is not guaranteed.
- Do not spray any liquids onto the appliance.
- Disconnect the mains plug before cleaning. Do not use any liquid or foam cleaners.
- Clean the appliance with a damp cloth.
- Connect the device according to the power supply on the rating plate.
- To prevent damage to the appliance, it is important that all appliances are properly earthed.
- Do not place any objects on the power cable and lay it in such a way as to avoid tripping hazards.
- Use a surge protector, a regulator or an uninterruptible power supply (UPS) to protect your system from sudden, temporary and reduced power.
- Secure the system cable and mains cable properly and ensure that no objects are pressing on the cable.
- Do not insert any objects into the appliance through the openings in the housing. There is a risk of a short circuit, which can lead to fire or electric shock.
- Do not attempt to repair the appliance yourself. Always contact an authorized customer service centre.
- If any of the following conditions occur, unplug the appliance and return it to an authorized service centre for repair
- The mains cable, power supply unit or plug for the power supply is damaged or worn;
- Liquid has penetrated the appliance;
- The device has been exposed to rain or water;
- The device has been dropped or the housing has been damaged;
- The function of the device has obviously changed;
- The appliance cannot be operated as described in the operating instructions.

**EU responsible person**

EU based economic operator ensuring the product complies with the required regulations.

ASSMANN Electronic GmbH  
Auf dem Schüffel 3  
Lüdenscheid, Germany  
<https://www.assmann.com>  
[info@assmann.com](mailto:info@assmann.com)